

READ BEFORE INSTALLATION

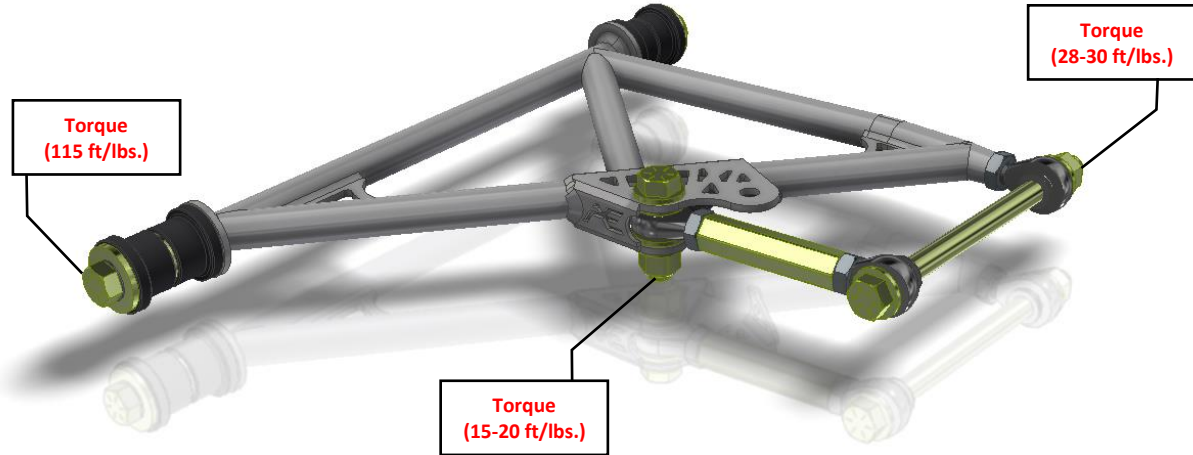

240z/260z/280z Rear Control Arm Installation Instructions

RECOMMENDED TOOLS AND SUPPLIES

- General Mechanics Tool Set
- Sockets: $\frac{15}{16}$
- Wrenches: $\frac{7}{8}$, $\frac{15}{16}$, $1 - \frac{1}{8}$,
- Torque wrench (capable of 115 ft/lbs)
- Jack and Jack Stands

NOTE: For any original hardware please refer to OEM service manual for torque specifications. For all included hardware please torque to specifications shown below.

SHARE US!!! Help us grow by sharing your experience! Thank you for your business!



@apexengineered
#apexengineered



APEX ENGINEERED

STEP 1:

- Collect the four (4) right hand (larger) and two (2) left hand rod ends (heim/rose joints).
- Thread two (2) larger right hand jam nuts onto the larger right hand rod ends.
- Thread two (2) right hand nyloc jam nuts onto the two (2) right hand rod ends.
- Thread the two (2) left hand jam nuts onto the two (2) left hand rod ends.

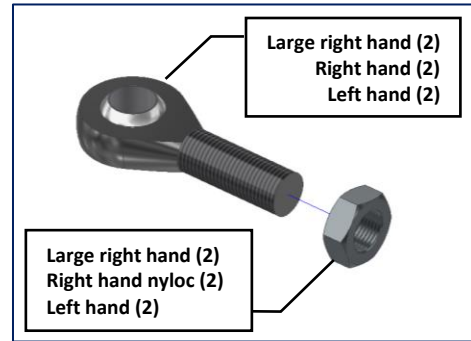

STEP 2:

- Thread one (1) right hand rod end and nyloc jam nut assembly into the right hand side of the adjuster.
- Thread one (1) left hand rod end and jam nut assembly into the left hand side of the adjuster.

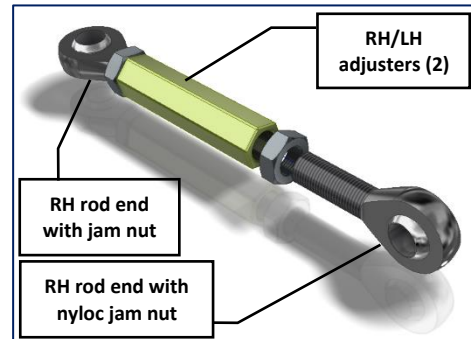

STEP 3:

- Collect two (2) 5/8 bolts, eight (8) 5/8 washers, two (2) nylon lock nuts.
- Assemble as shown.
- Torque to 15-20 ft/lbs using a 15/16 wrench and socket.
- Confirm the assembly is tight and correctly installed.

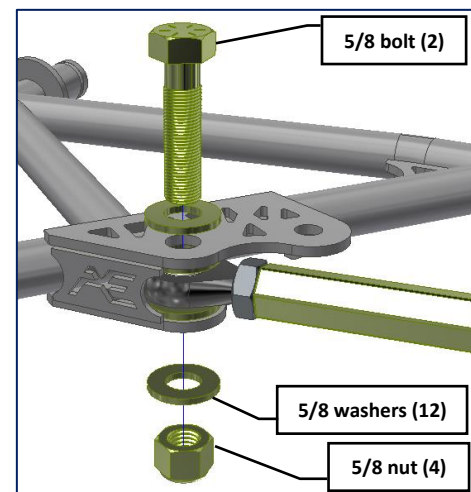

STEP 4:

- Collect the two (2) larger right hand rod end and jam nut assemblies from step one.
- Thread the larger right hand thread rod end with the right hand thread jam nut assembly into the housing as shown.

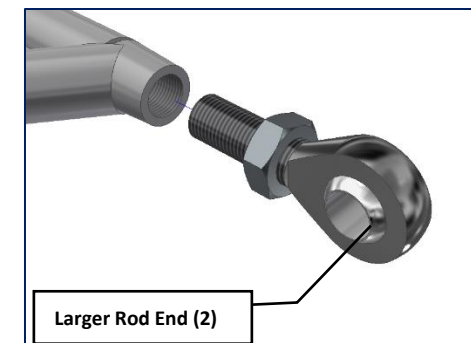

STEP 5:

- Collect the sixteen (16) aluminum washers, two (2) long 5/8" bolts, four (4) small outside diameter steel washers, and two (2) nylon inserted lock nuts.
- Assemble as shown.
- Hand tighten the nylon lock nut as you will need to assemble the strut into the control arm.
- Center the wheel as needed using the shim washers (ideal set up is to have strut spaced with even number of washers on each side).
- Once on the car, torque bolts to 28-30 ft/lbs.

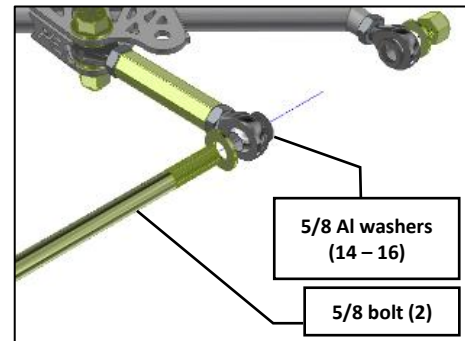

STEP 6:

- Collect the four (4) short bushings, four (4) long bushings, two (2) short sleeves and two (2) long sleeves.
- Assemble the bushings as shown with the short sleeves corresponding to the short bushings and same for the long.

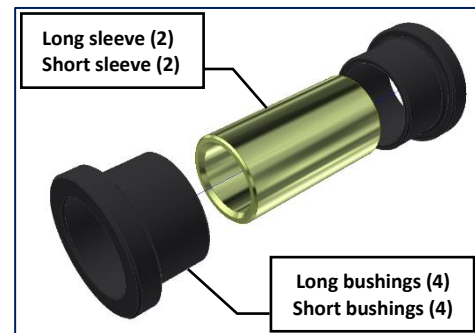

STEP 7:

- Collect the assembled bushing, four (4) large 5/8 washers, four (4) internal tooth washers, four (4) fine thread 5/8 bolts.
- Place the bushings on the correct side followed by the large 5/8 washer, internal tooth lock washer, and bolts in that order as picture shown.
- Only hand tighten the bolts as they will be tightened once on the car.
- Once on the car torque bolts to 115 ft/lbs.

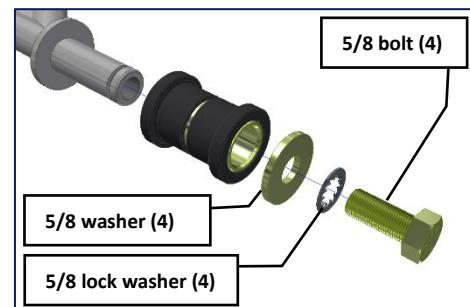

ALWAYS CHECK ALL COMPONENTS PRIOR TO EACH DRIVE TO ENSURE SAFETY

APEX ENGINEERED

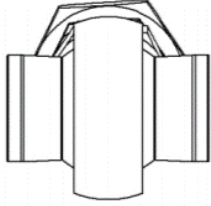

CORRECTLY POSITIONED

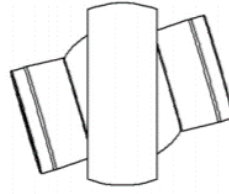

INCORRECTLY POSITIONED
TOO MUCH STATIC ROD END MISALIGNMENT

WARNING

High performance parts. For off-road use only. Installation should be carried out by a qualified facility. Improper use or installation may result in injury or death.

APEX ENGINEERED

apexengineered@gmail.com

www.apexengineered.com

SHARE US!!! Help us grow by sharing
your experience! Thank you for your business!



Be sure to tag us!

@apexengineered

#apexengineered

