

READ BEFORE INSTALLATION

240z/260z/280z Front Crossmember Installation Instructions

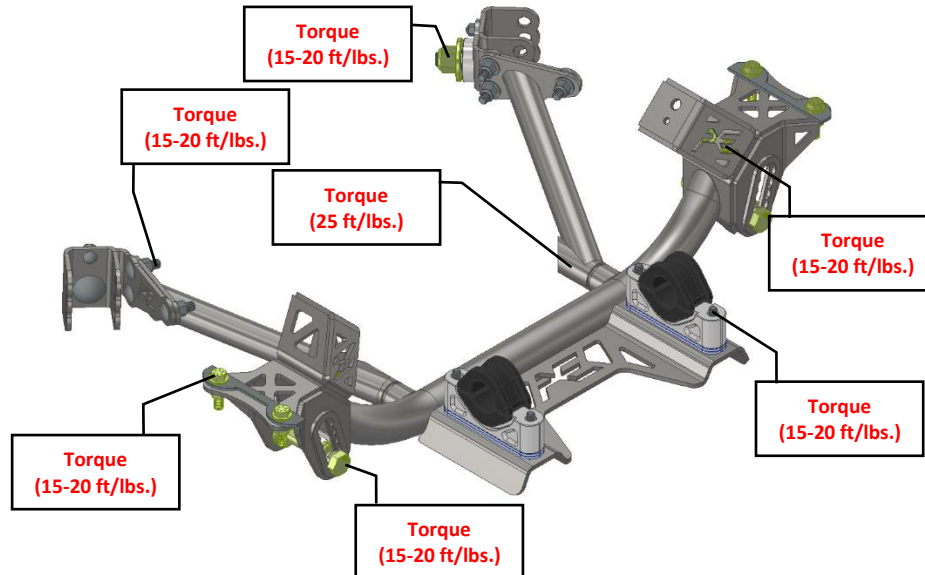

RECOMMENDED TOOLS AND SUPPLIES

- General Mechanics Tool Set
- Sockets: $\frac{9}{16}$, $\frac{3}{4}$, $\frac{15}{16}$, 22 mm
- Wrenches: $\frac{7}{16}$, $\frac{1}{2}$, $\frac{5}{8}$, $\frac{7}{8}$, $\frac{15}{16}$, 13mm, 22mm
- Sockets Drives (allen wrenches): $\frac{1}{2}$
- Torque wrench (capable of 30 ft/lbs)
- Jack and Jack Stands

NOTE: For any original hardware please refer to OEM service manual for torque specifications. For all included hardware please torque to specifications shown below.

SHARE US!!! Help us grow by sharing your experience! Thank you for your business!



@apexengineered
#apexengineered



STEP 1:

- Assemble components in order shown
- Place the cars body in between the crossmember and stock frame washers
- Place the washers on the stock frame washers followed by inserting the 3/8 bolt through
- Place the washers on the underside of the crossmember and begin to thread the 3/8 nuts
- Only hand tighten the nuts as some adjustments may be required.

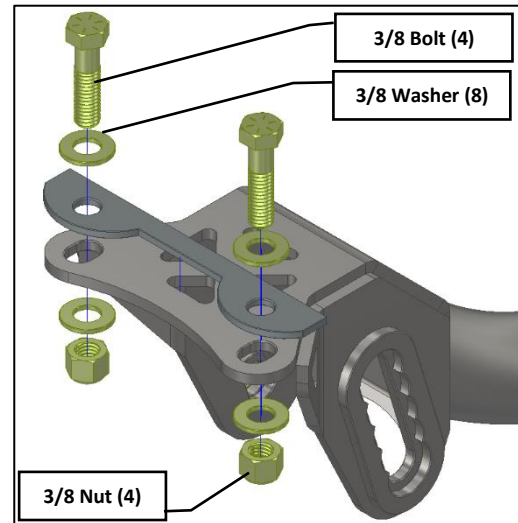

STEP 2:

- Assemble components as shown
- Note placement of the 7/16 nuts
- Tighten using a 5/8 wrench and socket.
- Torque to 15-20 ft./lbs.

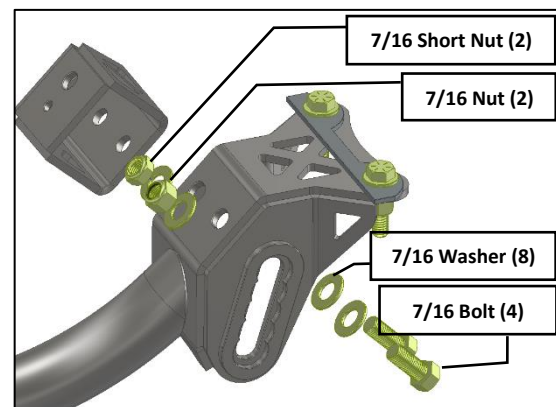

STEP 3

- Place the lock washer onto the socket head cap screw
- Being to thread the socket head cap screw into the crossmember using a 1/2 inch socket drive
- Only hand tighten the nuts as some adjustments may be required.

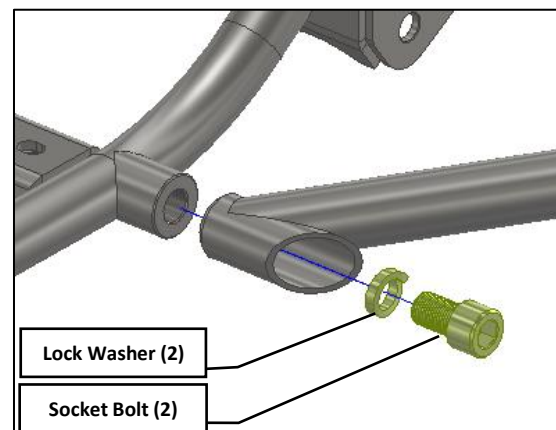

STEP 4:

(This step is for mock up to aid in the install)

- First, swing the loose braces down to the tension arm mounts on the car body
- Place the stepped spacer into the existing tension arm hole (Note: due to irregularities in the chassis, some installations may require drilling out existing tension arm hole)
- Take the formed "L" bracket and dry fit it to where the holes would relatively line up to the brace and the tension arm
- Clamps are a huge help in this process, be sure to double check all locations and hole alignments before drilling.
- Once holes are confirmed, mark using a visible marker and drill. Drill sizes can be from 3/8" to 1/2"

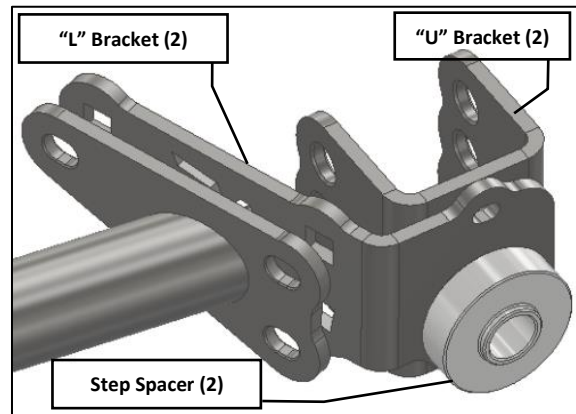

STEP 5:

- Assemble as shown
- First insert the 3/8 carriage bolts into the "L" bracket.
- Then put the 1/4 carriage bolt in the small square on the "U" bracket and hand tighten the 1/4 nut onto it.
- Place the aluminum stepped washer into the existing tension arm hole.
- Take the assembly to the car and insert the 3/8 carriage bolts into the drilled holes and through the braces.
- Once you have confirmed all hole placement, orientate the "U" bracket so that the 5/8 carriage bolt will be able to be inserted in the large "U" bracket slot and through the aluminum step washer.
- Once completed, remove assembly and tighten the 1/4 nut to 15-20 ft/lbs.
- Hand tighten the 3/8 nuts.
- Place the 5/8 carriage bolt into the large slot in the "U" bracket and place the 5/8 washer on the opposite side of the cars tension arm bracket.
- Tighten the two 5/8 socket head bolts attaching the braces to the crossmember to 25 ft/lbs
- **NOTE: The stepped aluminum washer may be a press fit on your car**, you can either tighten the assembly until the washer sits flat to the car body, or drill out the hole.
- **NOTE: As these cars have a lot of variance in the body, items may not be tight fits and may need some modifications to install.**
- **NOTE: Stock tension arm location is lowest hole in the "U" bracket**

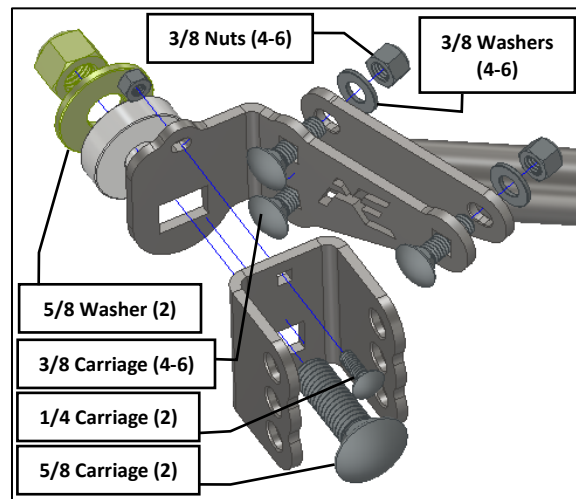

STEP 6:

- Assemble as shown
- Place shims first, then bracket as shown
- Place the 3/8 washers onto the M8 bolts
- Once steering rack bushings and steering rack is placed, install the steering rack clamps by tightening the M8 bolts into the clamps. Tighten bolts to 15-20 ft/lbs.

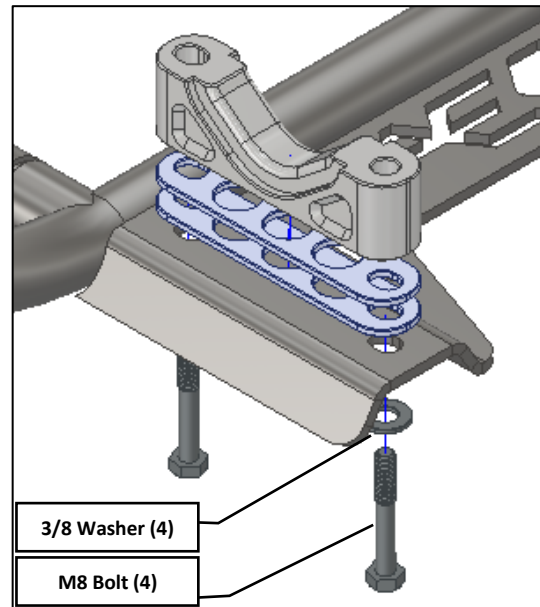

STEP 6:

- Assemble as shown
- First alignment washers onto the M14 bolt
- Insert bolt and washer into desired crossmember hole
- Before putting the M14 bolt through both sides, insert the thick washers onto bolt.
- Depending on the control arm you use, you may need to replace the thick washers with thinner ones or remove/add washers.
- Be sure to have minimal to no slop in the control arm mounting assembly.
- Tighten M14 bolt to 15-20 ft/lbs. and confirm no slop in control arm mounting assembly.
- **NOTE: Stock control arm location is lowest and furthest inward location.**

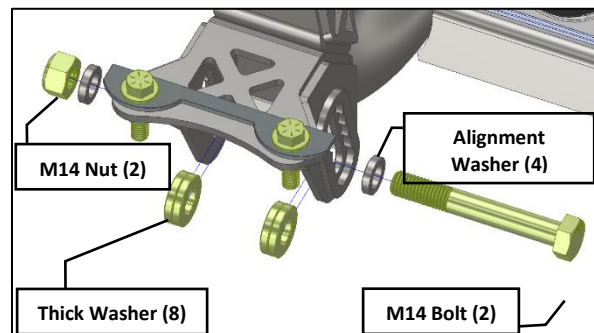

ALWAYS CHECK ALL COMPONENTS PRIOR TO EACH DRIVE TO ENSURE SAFETY

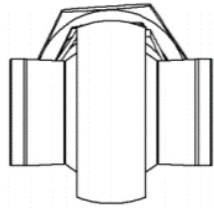

CORRECTLY POSITIONED

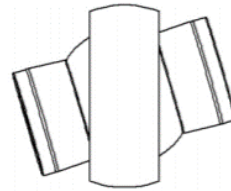

INCORRECTLY POSITIONED
TOO MUCH STATIC ROD END MISALIGNMENT

WARNING

High performance parts. For off-road use only. Installation should be carried out by a qualified facility. Improper use or installation may result in injury or death.

Apex Engineered

apexengineered@gmail.com

www.apexengineered.com

SHARE US!!! Help us grow by sharing your experience! Thank you for your business!



Be sure to tag us!
@apexengineered
#apexengineered





Apex Engineered LLC
240z/260z/280z
Front Crossmember
Instructions